

RoHS Component

"*" Pivot Dimension

PO(XXX)	A ±0.25	B ±0.13	C ±0.38	D ±0.25
009	16.33	24.99	30.81	19.28
015	24.66	33.32	39.14	27.51
025	38.38	47.04	53.04	41.28
037	54.84	63.50	69.32	57.71

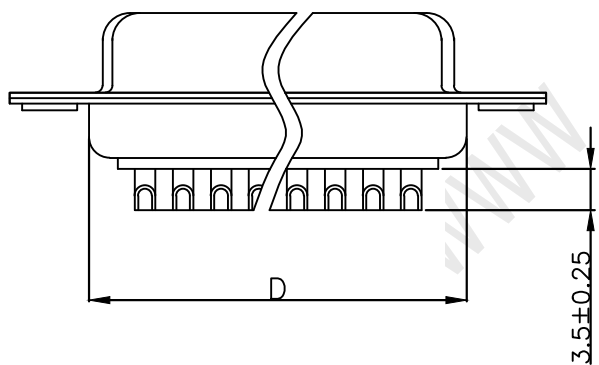
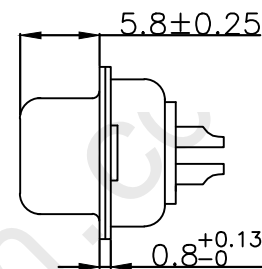
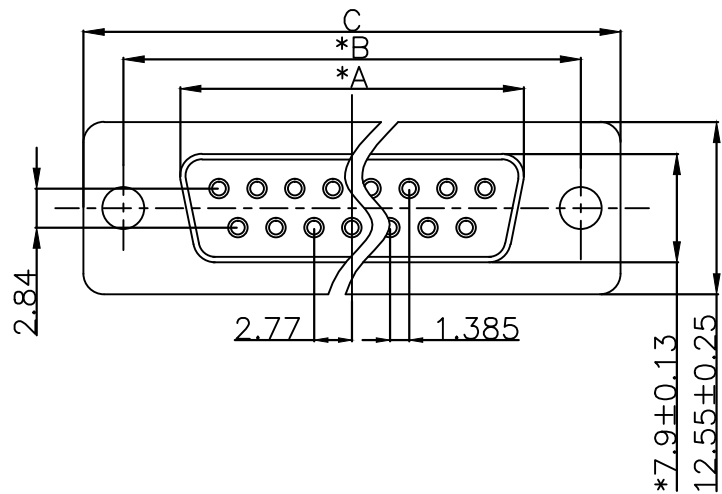

NOTICE :

1. ELECTRICE:

- DIELECTRIC RATING: 300V
- CONTACT CURRENT RATING: 5AMP
- CONTACT RESISTANCE: 15mΩ MAX.
- INSULATION RESISTANCE: 1000MΩ MIN. at 500V DC
- DIELECTRIC STRENGTH: 500V AC RMS for 1Minute
- OPERATION TEMPERATURE: -55C° ~125C°

2. MATERIAL:

- INSULATOR: PBT+30% G. F (UL94V-0)
- CONTACT: COPPER ALLOY
- CONTACT PLATED: GOLD FIASH OVER NICKEL
- SHELL: SPCC
- SHELLPLATED: NICKEL/TIN

TOLERANCE: X.X ±0.38 X.XX ±0.25 X.XXX ±0.13 X° ±5° X.X° ±2°	DRAWN BY :	DATE :	PART NAME:	
		2009. 08. 22	IBL-DBXXX-2F	
	CHECKED BY:	DATE :	DRAW NO.	
		2009. 08. 22	PART NO.	
UNIT: mm [inch] SCALE:1:1 SIZE: A4	APPROVED BY:	DATE :	REMARK	
		2009. 08. 22	MOLD NO.	